





Shows optional VELUX® rooflight, see page 71

The Ambleside

Cook up happiness here. Generously designed with a fine dining kind of life in mind, drenched in sunshine, smattered with traditional wooden touches and opulent fabric finishes, it's a deliciously delightful stay.



Idyllic all year round

Please note: Some items featured in this photography are scene-setting props or optional extras, not included in your purchase. Please speak to your park or dealership or refer to the 'all this included' section for this holiday home.





Shows optional full front sliding doors and VELUX® rooflight, see page 71



Shows optional full front sliding doors, see page 71

Highlights:

- **Stunning kitchen with integrated appliances**
- **Home-from-home styling**
- **14ft Premier Pack available providing more space and double bed option in twin room**
- **Large, comfortable free-standing sofas**
- **Optional panoramic sliding doors**
- **En suite shower**
- **Updated colour scheme for 2024**

The Ambleside

If you can already see yourself here, enjoying stays in all four seasons, then perhaps it's time to pick the layout you'd love - there are four different models.

For external CanExel™ Cladding option please visit www.abiuk.co.uk



For more information and to take a virtual tour, visit www.abiuk.co.uk

All this included

- ✓ Matt finish Chateaux grey aluminium cladding
- ✓ Pre-galvanised twin axle chassis
- ✓ Graphite grey 'Low E' PVCu Thermaglass double glazing
- ✓ Front French doors
- ✓ Fully condensing boiler gas central heating
- ✓ Log burner style electric fire
- ✓ Carpet underlay throughout
- ✓ Free-standing dining table and chairs
- ✓ Upholstered footstool
- ✓ Satellite co-ax
- ✓ USB socket in lounge
- ✓ Scatter cushions in lounge
- ✓ Voiles throughout
- ✓ Soft-close drawers throughout
- ✓ Integrated oven and separate 5 burner hob
- ✓ 40mm worktops
- ✓ Integrated fridge freezer
- ✓ Externally vented powered cooker hood
- ✓ Lift-up bed in master bedroom
- ✓ TV point in all bedrooms
- ✓ USB sockets in all bedrooms (includes USB sockets on both sides of the main bed)
- ✓ King size bed in master bedroom (2 bedroom model only)
- ✓ Plain duvet covers and pillowcases
- ✓ Bed runners and scatter cushions on all beds
- ✓ Separate en suite toilet and shower
- ✓ Bathroom extractor fans

- ✓ Shaver socket
- ✓ Coat hooks in all bathrooms
- ✓ Entrance hall
- ✓ Composite kitchen sink
- ✓ Wicker storage baskets in kitchen
- ✓ Wall lighting in lounge

Add any of these

- Premier Pack
- Residential specification BS3632
- 'Exclusive' pocket sprung mattresses
- Integrated dishwasher
- Integrated washing machine
- Integrated microwave oven
- Fully galvanised chassis
- Deluxe Bluetooth sound system
- Second bedroom as double instead of twin, bed includes lift-up storage (Premier model)
- CanExel™ exterior cladding
- Space saver bed in twin room
- Additional window in lounge nearside corner
- Full front sliding door in lieu of front French doors
- VELUX® rooflight window to kitchen

The Ambleside Premier Pack

- ✓ Light grey hard PVCu cladding
- ✓ 14ft wide
- ✓ Larger sofa
- ✓ 3' beds in twin room
- ✓ Dressing table with stool in twin room (2 bedroom model only)

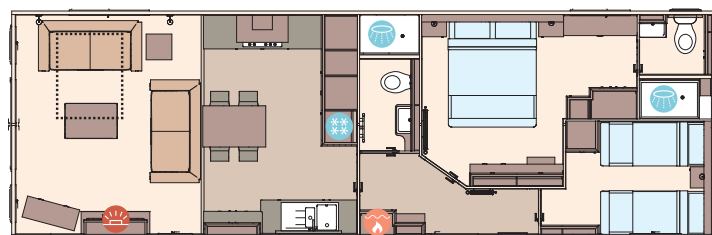

The Ambleside 40ft x 13ft x 2 bedroom

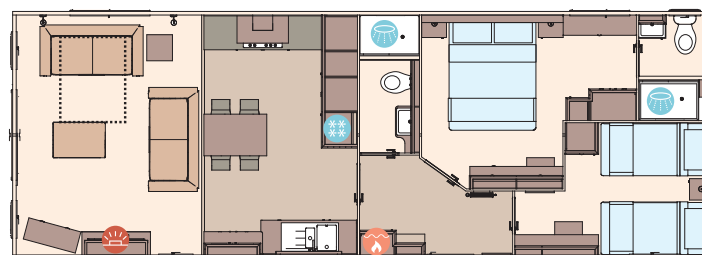

The Ambleside Premier 40ft x 14ft x 2 bedroom

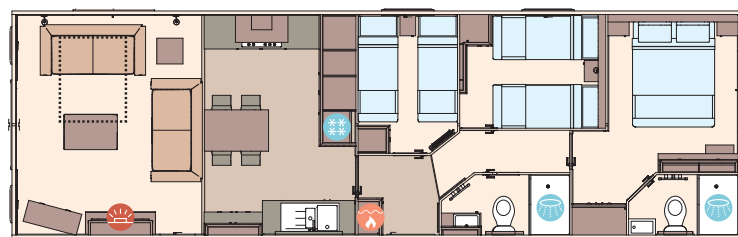

The Ambleside 41ft x 13ft x 3 bedroom

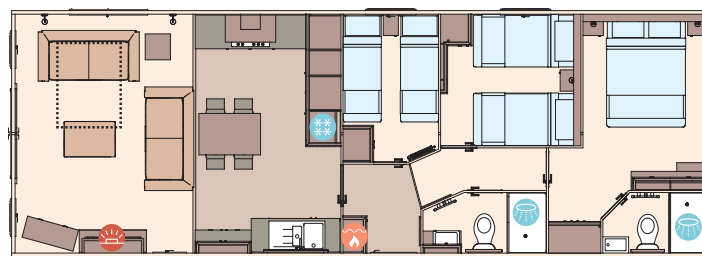

The Ambleside Premier 41ft x 14ft x 3 bedroom

KEY: Fire Water heater Shower Fridge/Freezer Front pull out bed

OPTIONAL
Residential
specification
BS3632
See Page 86